



[congress.zillertal](https://congress.zillertal.com)

EUROPA HAUS



MEETINGS WITH A VIEW & HEARTFELT HOSPITALITY



WELCOME

to the Europahaus Mayrhofen

The Zillertal valley combines traditions and modern technology. You can feel the passion for mountains, culture and sports in every corner, along with generations of hospitality. This is also noticeable at the Europahaus Mayrhofen.

With over 40 years of hosting, organizing & handling events, the Europahaus & town of Mayrhofen are the perfect setting for your vision. The three pillars congress.zillertal, kultur.mayrhofen and waldfest.platz make up the heart of the Europahaus concept, which offers space for meetings with a view, right outside our doorstep.

INSPIRING MEETINGS

Business and mountains have a lot in common: both require passion, persistence, and a clear vision of where you want to end up. We at Europahaus Mayrhofen understand those needs and offer space for your very own congress-summit experience. Our unique location offers the best of both worlds: the alpine town's infrastructure and facilities with the energy and beauty of the surrounding mountains.

OUR EXPERIENCE – YOUR VISION

The Europahaus looks back onto a well-known history of successful and creative events which makes it one of the most renowned congress centres in Austria nowadays. With over 500 events held annually, the entire building was renovated in 2010 with the needs of our many returning customers in mind. Timeless, modern, and functional!



EUROPA
HAUS

CONGRESS



CONGRESS.ZILLERTAL

The Europahaus is shaped like a crystal and offers flexible floor plans on all three levels: 1 plenary and up to 8 breakout rooms, 1.200 m² of exhibition space, 4 stages from 14-40 m² and conference capacities for 10-800 participants. Create your event with our state-of-the-art lighting, audio and air conditioning systems. Extend your meeting with several breakout rooms in hotels within walking distance.

„Competence, responsibility and professionalism: These words describe the work ethics of the entire Europahaus team. We're excited to have you as part of our rent a village by xnet® destinations, to more future events in the beautiful village of Mayrhofen and especially to you in the Europahaus. See you soon in your village!“

Karl Schwärzler
Managing Director &
Owner xnet ag



congress.zillertal

KULTUR

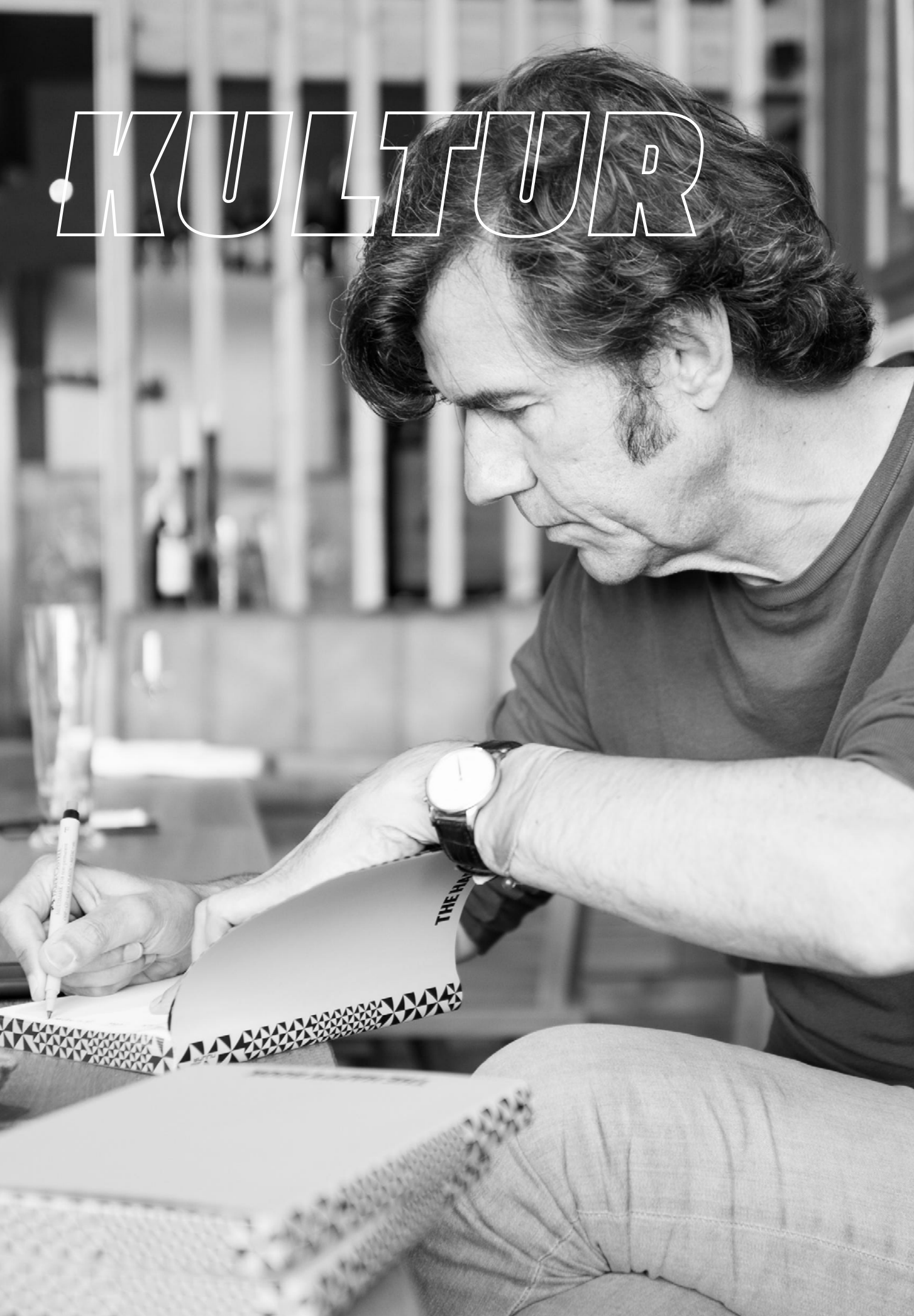

KULTUR.MAYRHOFEN

Zillertal is known as the "valley of music" with over 100 bands and home to century-old traditions. These deep roots in local culture are what motivates us to create "a stage for everyone". Our events target locals and guests alike with authentic art, culture, and music.



„It is incredibly important that the spirit and soul are also trained in Austria's skiing and hiking regions. The Europahaus in Mayrhofen sets new standards in this regard.“

Stefan Sagmeister
Austrian graphic designer
based in New York



WALDFEST.PLATZ

This open-air forest location has hosted festivities and concerts for over 100 years. Our goal is to continue its cultural heritage while conserving the natural spirit and honour the local culture and community.

The waldfest.platz could be your outside meeting room. Connect offline in midst of pine trees and mountains, use nature as a base for your constructive & unconventional meeting!



"Even the short walk from the Europahaus to the forest site in Mayrhofen allowed for an unconventional and exciting exchange among the participants. In the middle of the forest and fresh air, new and progressive ideas started to flow. The regional, healthy and varied buffet from the in-house caterer made our day even tastier."

Veronika Schumann
Head of Convention
Bureau Tyrol



HARD FACTS

- 40 years of MICE experience
- First opened in September 1979
- Renovated in May 2010
- Maximum capacity: 1.600 persons

What sets us apart

- Professional hosts with international experience
- One-stop-shop for arrival, accommodation, catering, activities, etc.
- Flexible floor plans tailored to your needs, mobility on all levels
- Timeless architecture in balance with tradition and modernity
- 3.000 guest beds within walking distance, over 17.000 in the region
- Access to two alpine resorts directly from Mayrhofen centre
- Countless activities & teambuilding options all year round in the village and on the mountains

Highlights & USPs

- Business & mountains are just a glass wall apart: ideal combination of meetings, nature, and activities
- Alpine meeting spaces: "connect offline" in mountain hut or in the forest
- Our long-time & well-coordinated team make you feel right at home

„I have already conducted our Ophthalmological Winter Academy twice in the Europahaus Mayrhofen. There are no words to truly reflect our enthusiasm and satisfaction with this venue. The infrastructure is more than perfect, the employees from technicians to management are extremely professional, courteous, and friendly. The catering is phenomenal. Simply perfect!! We will definitely be back.“

Mag. Karlheinz Hannig
CEO & owner mts-the wetlab company GmbH



OVERVIEW

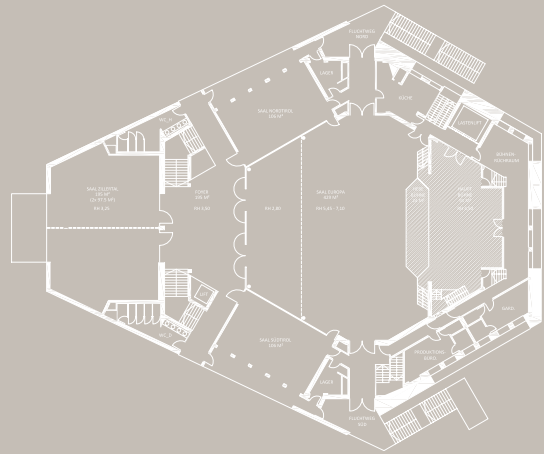

First floor

Plenary Europa	280 - 641 m ²
Balcony	-
Room Südtirol	106 m ²
Room Nordtirol	106 m ²
Foyer	195 m ²
Room Zillertal	195 m ²
Room Zillertal "Nord"	975 m ²
Room Zillertal "Süd"	975 m ²

Backstage 1	18 m ²
Backstage 2	19 m ²
Stage total plenary Europa	117 m ²
Mobile stage (2,5 x 8,5 m)	21 m ²
Main stage (8 x 12 m)	96 m ²

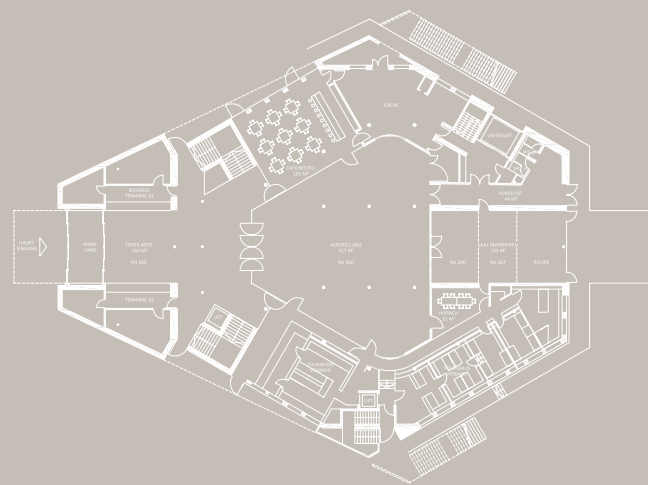

Ground floor

Exhibition/catering space	317 m ²
Room Mayrhofen	103 m ²
Counter	54 m ²
Café	101 m ²
Foyer	164 m ²

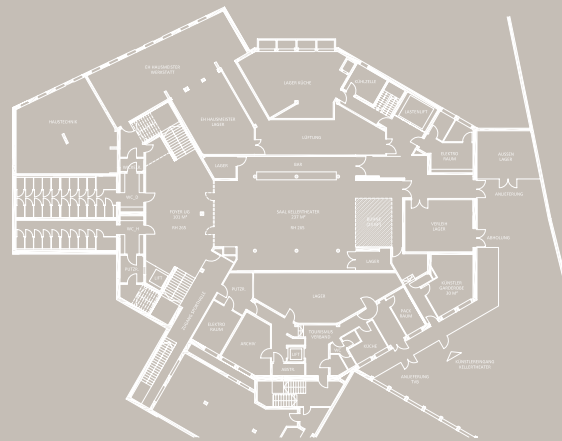

Basement

Room Kellertheater	200 m ²
Foyer	101 m ²

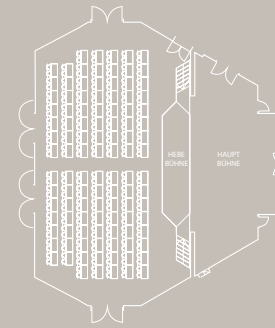

Plenary Europa, XS, 1st floor

337	200	170

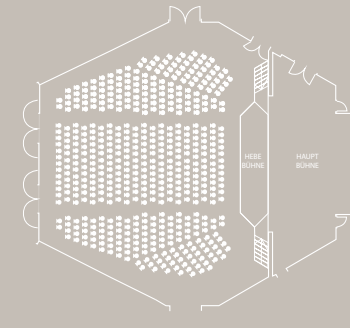

Plenary Europa, 1st floor

532	300	240

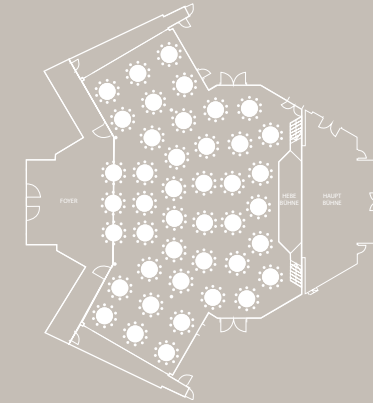

Plenary Europa, XL, 1st floor

724	428	430

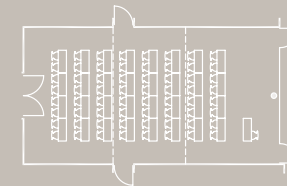

Room Mayrhofen, ground floor

90	60	32

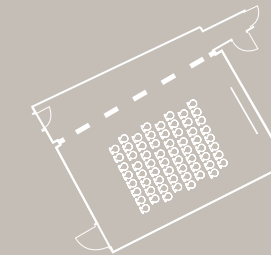

Room Nordtirol, 1st floor

70	50	24

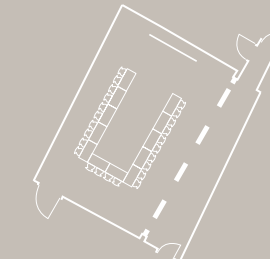

Room Südtirol, 1st floor

70	50	24

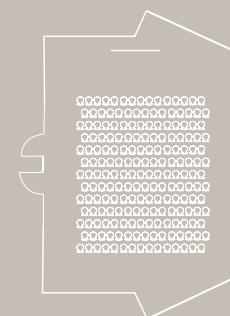

Room Zillertal, 1st floor

230	140	40

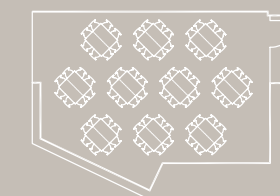

Room Zillertal Nord, 1st floor

100	60	24

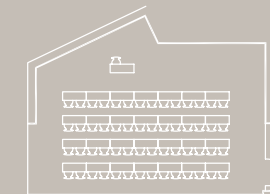

Room Zillertal Süd, 1st floor

100	60	24

Theatre seating classroom seating U-shape banquet style

CULINARY DELIGHTS AT EUROPAHAUS WITH CATERING.PINTER

The Zillertal valley not only offers untouched nature but also unique and organic products. Seasonal and local food are used to prepare most delicious and healthy coffee breaks, meals and gala dinners. Our clients can taste where the food comes from! Samuel Pinter has been our exclusive in-house caterer since 2018 and knows how to combine traditional cuisine with culinary trends. The experienced chef and his team guarantee individual catering options customized to our guests needs.

"Food is an often overlooked but crucial factor when planning events. With our caterer Samuel Pinter we focus on quality & sustainability. Whether it's a snack during a coffee break or a multi-course-dinner – you can always taste the local heritage, passion, and tradition!"

Mag. Stefanie Thurner
Manager
Europahaus



CATERING



SUMMER

MAYRHOFEN IN SUMMER

Summer holidays have over 150 years of tradition in the Mayrhofen-Hippach area, which is unusual for an alpine resort. The combination of music & mountains attracts guests from all over the world! Nestled within the high alpine natural park with vast fields and striking peaks, the region offers countless outdoor activities to enhance your meeting experience: Hiking, biking, climbing, trail running and more; fantastic routes, magnificent panoramas, and quaint places to stop for refreshments. For quick and easy access, two gondolas take you from Mayrhofen centre to the action resort "Penken" and the mountain plateau "Ahorn".

"As a mountain runner, I really appreciate Mayrhofen and its sports facilities. After a hard day's work, I find balance with a run along the Ziller river or up Mt. Ahorn. Thanks to the excellent infrastructure and local competence, events like the Harakiri-mountain-run take place - where the elite of the mountain running scene meets."

Markus Kröll
Mountain running
champion



congress.zillertal

MAYRHOFEN IN WINTER

Located in the heart of the Tyrolean mountains and surrounded by impressive 3,000-meter peaks, Mayrhofen not only spoils its guests with 142 km of perfectly prepared slopes and 60 modern lifts, but also shows how sporty and versatile, stylish and relaxed, surprising and exciting the winter season in Zillertal valley can be.

Fast-paced fun on the slopes, stamina enhancing sessions on cross-country ski trails, exciting toboggan rides, or snowshoe hikes through pristine natural landscapes - winter in the Mayrhofen-Hippach region has a whole host of enticing facets. This is where perfectly groomed slopes converge with culinary diversity and lively tradition, the perfect addition to your professional event!



"Mountaineering is a sport of superlatives: higher, faster, stronger! It requires courage, focus, ambition, and a certain spark of innovation – just like in our professional lives. In my lectures at Europahaus, I like to point out these parallels of sports and business. Many companies are pulled into the 'most active valley on the planet', just as it brought me back from Mt. Everest to Zillertal valley - higher, faster, and stronger!"

Peter Habeler
Mountaineer, first ascent
without supplemental
oxygen of Mt. Everest



ABOUT US

OUR TEAM

A small team to your advantage: quick and easy communication with professionals on all levels. We are familiar with every aspect of the workflow and know our facilities inside-out. Our hospitality will make you feel right at home.

OUR VALUES

We're looking for solutions, not problems. If our location isn't the right fit for your event, we will let you know. Transparency & authenticity are our core values!

Flexibility is our second nature, and we enjoy cooperating with our clients as equals. No event is like the other, we dive head-first into every new challenge with our passion and experience. We celebrate collaboration and cooperation with our clients and local service partners. This unique combination guarantees your event's success!

MEANINGFUL CONNECTIONS

The Europahaus strives to be a melting pot of equality. Our premises and the Zillertal mountains offer the ideal conditions for holding events in a sustainable and regional manner, all while creating a lasting culture of togetherness, learning and personal development. Zillertal locals are practically born with hospitality, it's our sixth sense. The passion to share our facilities and home with our customers is what drives us. We see ourselves primarily as partners - nothing is more important than to support our customers to enjoy a successful event. Our greatest gift is to send them off with a satisfied smile on their faces.



congress.zillertal

RIGHT OUTSIDE YOUR DOORSTEP

Within 12 minutes walking distance of Europahaus:

- 3.000 guest beds of all categories
- Train station with the century-old steam train
- Berghof event hall
- Mayrhofen main street with shops, restaurants, and cafés
- Two gondolas to the mountain resorts with Austria's largest gondola, the igloo hotel & bar "White Lounge", falconry, etc.
- Countless special event locations like the Dairy experience or the oldest restaurant from the 1600s
- Waldfest.platz open air forest location
- 3 via ferratas

Around Mayrhofen:

- 159 km of slopes
- Hintertux glacier open all year round
- 800 km of hiking & bike trails
- Mountain huts with breath-taking views
- Zillertal Alps Nature Park
- 4 side valleys

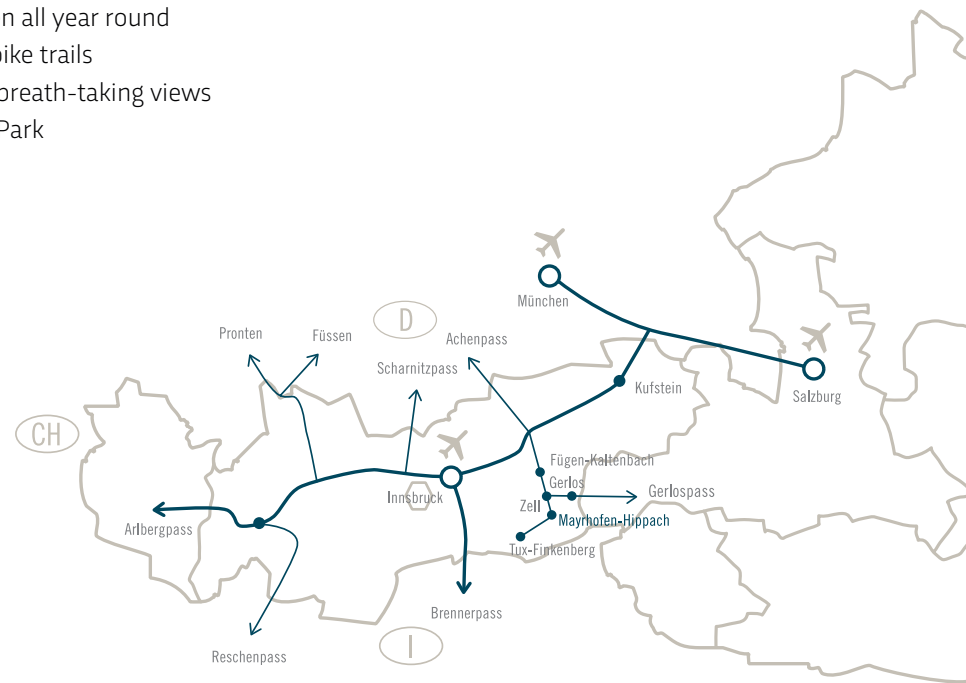

HOW TO GET HERE

By plane (distance to airport):

- Munich: 190 km
- Salzburg: 170 km
- Innsbruck: 65 km

By car:

Highway A12, exit "Zillertal", around 30 km along B169 until you reach Mayrhofen

By public transport:

Switch at train station "Jenbach" (connected to European railway system) to the local "Zillertalbahn" bus or train for 35 km to last stop: Mayrhofen

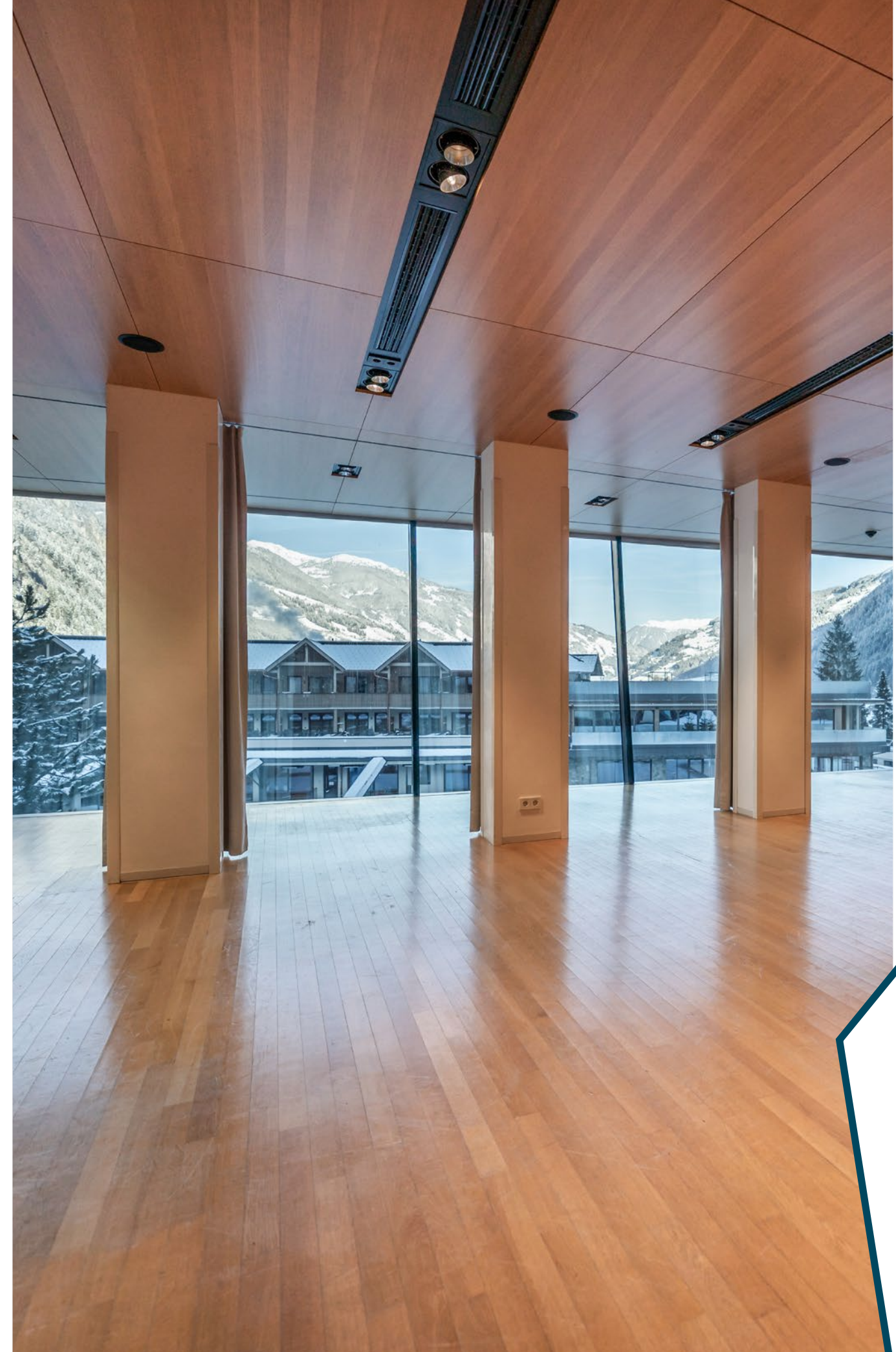



Europahaus Mayrhofen
Dürster Strasse 225
6290 Mayrhofen
+43 5285 6750
office@europahaus.at
www.europahaus.at/en

congress.zillertal